

# Switchcraft®

[Previous Page](#) | [Return to Index](#) | [Next Page](#)

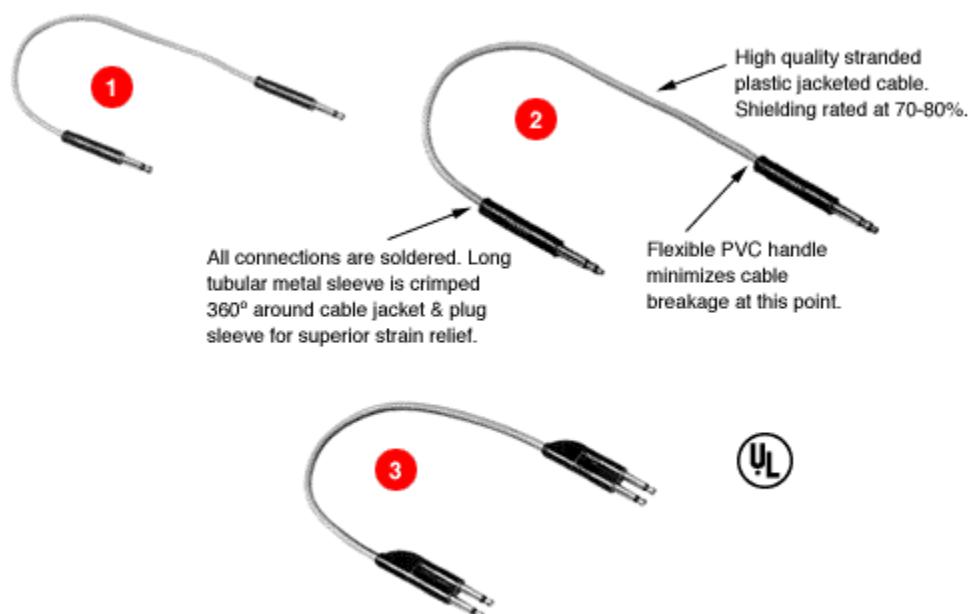

## MINIATURE TT® MOLDED PATCH CORDS

- 1. Series TT100
- 2. Series TT120
- 3. Series TT140

[click here to download a schematic drawing](#)

(you will need to have Adobe Acrobat installed on your system to do this)



Available in a variety of types and lengths to meet requirements of communication, industrial and telephone applications. Patch cords designed to be used in "tini-telephone" jack panels. Constructed of high quality cadmium bronze conductors with thermoplastic insulating material. Braided shield offers 70-80% coverage. All plugs are molded of flexible thermoplastic (in gray or colors) with non-slip finger grip areas. All cords (gray or colors) have a label identifying Switchcraft part number and length. Plug fingers are natural or nickel-plated copper alloy.

### **SERIES TT100 2-CONDUCTOR PATCH CORDS**

Single-conductor shielded cable with 2-conductor phone plug molded at each end. Shield is grounded to sleeve of each plug; wiring is tip-to-tip. Plug fingers are brass; handles and cable are gray.

### **SERIES TT120 3-CONDUCTOR PATCH CORDS**

2-conductor shielded cable with 3-conductor phone plug molded at each end. Shield is grounded to sleeve of each plug; wiring is tip-to-tip and ring-to-ring. Plug fingers are brass or nickel; handles and cable are gray or colored.

<b>Part Numbers<sup>4</sup></b>		<b>Length<sup>1</sup> feet(m)</b>
<b>Series TT100</b>	<b>Series TT120</b>	
TT101*	TT121	0.5 (.152)
TT102*	TT122	1.0 (.305)
TT103*	TT123	1.5 (.457)
TT104	TT124	2.0 (.610)
TT105*	TT125*	2.5 (.762)
TT106*	TT126	3.0 (.914)

TT107	TT127	4.0 (1.219)
TT108	TT128	5.0 (1.524)
TT109*	TT129	6.0 (1.829)
TT110*	TT130*	7.0 (2.134)
TT111*	TT131*	8.0 (2.438)
TT112*	TT132*	9.0 (2.743)
TT113*	TT133*	10.0 (3.05)
TT114*	TT134*	11.0 (3.353)
TT115*	TT135*	12.0 (3.658)

\*Special order only; contact Switchcraft for prices and delivery.

### **SERIES TT140 2-CONDUCTOR TWIN PATCH CORDS**

2-conductor shielded cable and a pair of 2-conductor phone plug fingers molded at each end. Sleeve circuits are common and attached to shield. Wiring is tip-to-tip for each finger. Flexible handles permit self-alignment by compensation for any variation of jack mounting centers.

### **SERIES TT160 3-CONDUCTOR TWIN PATCH CORDS**

Similar to Series TT140, except uses a 4-conductor shielded cable with a pair of 3-conductor phone plug fingers molded to each end. Circuits are wired tip-to-tip and ring-to-ring.

### **SPECIFICATIONS**

**Cable:** Plastic jacket, cadmium bronze conductors, braided shield.

**Jacket color:** gray. Other colors available on special order.

**Plugs:** Tip Rod, Ring and Sleeve - Copper alloy.

**Handle:** Molded thermoplastic. Handle color: gray. Other colors available (on special order for TT100, TT140, TT160).

### **ORDERING**

1. Order by part number
2. For special order items, contact Switchcraft with details.

		<b>Length</b>
--	--	---------------

<b>Part Number Series TT120</b>	<b>Description<sup>2,3</sup></b>	<b>feet (m)<sup>1</sup></b>
<b>TT121N0</b>	Nickel-plated plug fingers, black handles and cord.	0.5 (.152)
<b>TT122N0</b>		1.0 (.305)
<b>TT123N0</b>		1.5 (.457)
<b>TT124N0</b>		2.0 (.610)
<b>TT125N0*</b>		2.5 (.762)
<b>TT126N0</b>		3.0 (.914)
<b>TT127N0</b>		4.0 (1.219)
<b>TT128N0</b>		5.0 (1.524)
<b>TT129N0</b>		6.0 (1.829)

<sup>1</sup> Length of patch cord is measured from rear of molded plug handle to the rear of molded plug handle at opposite end.

<sup>2</sup> For brass fingers on plugs, substitute "B" for "N" in part number. Special order only.

<sup>3</sup> "0" in part numbers denotes black handles and cord. Substitute the following for "0" to specify other colors: 2-Red 5-Green 4-Yellow 6-Blue

<sup>4</sup> Special order only. Plug fingers are brass.

<b>Part Numbers</b>		<b>Length feet (m)</b>
<b>Series TT140</b>	<b>Series TT160</b>	
<b>TT141*</b>	<b>TT161</b>	0.5 (.152)
<b>TT142*</b>	<b>TT162</b>	1.0 (.305)
<b>TT143*</b>	<b>TT163</b>	1.5 (.457)
<b>TT144*</b>	<b>TT164</b>	2.0 (.610)
<b>TT145*</b>	<b>TT165</b>	2.5 (.762)
<b>TT146*</b>	<b>TT166</b>	3.0 (.914)
<b>TT147*</b>	<b>TT167</b>	4.0 (1.219)
<b>TT148*</b>	<b>TT168</b>	5.0 (1.524)
<b>TT149*</b>	<b>TT169</b>	6.0 (1.829)

<b>TT150*</b>	<b>TT170*</b>	7.0 (2.134)
<b>TT151*</b>	<b>TT171*</b>	8.0 (2.438)
<b>TT152*</b>	<b>TT172*</b>	9.0 (2.743)
<b>TT153*</b>	<b>TT173*</b>	10.0 (3.05)
<b>TT154*</b>	<b>TT174*</b>	11.0 (3.353)
<b>TT155*</b>	<b>TT175*</b>	12.0 (3.658)

\*Special order only; contact Switchcraft for prices and delivery.

[Previous Page](#) | [Return to Index](#) | [Next Page](#)

**To search a category please click on the corresponding icon:**



| [Connectors](#) | [Jacks and Plugs](#) |  
| [Patch Panels, Patch Kits & Jackfields](#) | [Cable Assemblies and Patch Cords](#) | [Switches](#) |

**All products shown are covered by Switchcraft's limited lifetime warranty.**

| [Switchcraft home](#) |  
[About Us](#) | [Products](#) | [What's New](#) | [Search](#) | [Contact Us](#)