

SPRING-LOADED CONNECTORS

SERIES 806 • REMOVABLE PICK & PLACE CAP, SPRING-LOADED PINS • THROUGH-HOLE MOUNT

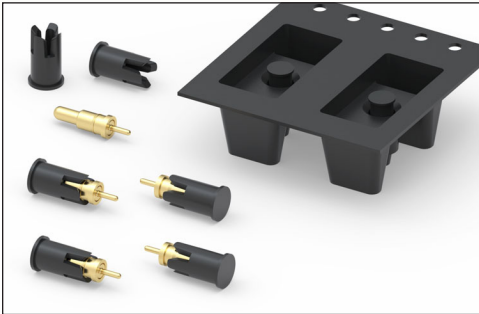

- Through hole mount spring-loaded pins with removable pick & place cap are available in four heights from 3,5 to 5,0 with a working travel of either 0,5 or 0,7
- Spring pins used in this series are Mill-Max 0906-X (see page 25 for more details)
- The pick & place cap allows individual spring-loaded contacts to be packaged on tape and reel for automated assembly. The caps are easily removed after soldering leaving only the spring pin on the board
- Pick & place cap material is high temperature thermoplastic suitable for most SMT soldering processes
- Supplied on 24 mm wide carrier tape, 330mm reels; packaging per EIA-481. See below for ordering information

Series 806 (Contact Style 1-4)

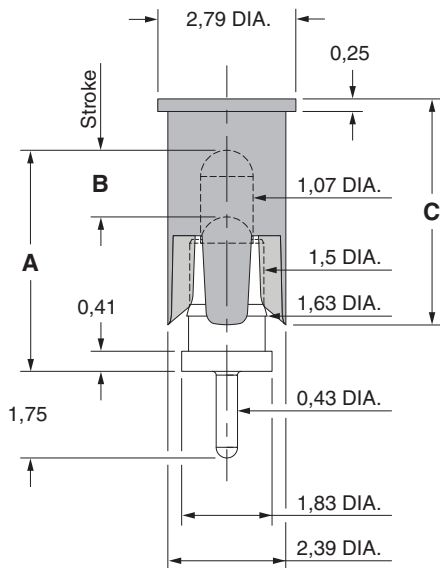

Series 806 (Tape Pocket Depth)

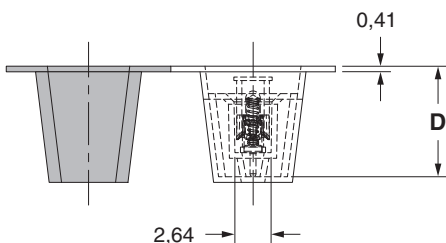

ORDERING INFORMATION

Series 806 (Tape & Reel Packaged)

806-22-001-10-00X191

Specify contact style 1-4

Contact Style	Initial Height (A)	Working Travel	Full Stroke Range (B)	Sleeve Height (C)	Tape Depth (D)	Quantity per Reel
1	3,5	0,5	0,76-1,0	4,57	8,05	640
2	3,94	0,5	0,76-1,0	4,57	8,05	640
3	4,5	0,7	1,27-1,4	4,57	8,05	640
4	5,0	0,7	1,27-1,4	4,57	8,05	640

Technical Specifications

Materials:

Contact piston & base: Machined copper alloy plated 0,51µm gold over 2,54µm nickel
 Spring (Contact style 1-4): Beryllium copper-plated 0,25µm gold
 Insulator: High temperature thermoplastic, rated UL94 V-0

Mechanical:

Spring force @ initial height (A) (Contact style 1-4): 25 grams
 Spring force @ mid stroke (B/2) (Contact style 1-4): 60 grams
 Durability: Up to 1,000,000 cycles

Electrical:

Current rating: 2A (continuous), 3A (peak) per contact
 Contact resistance: 20mΩ max.
 Insulation resistance: 10,000MΩ min.

RoHS-2
2011/65/EU

