

| 4 | | 3 | | 2 | | 1 | |
|------|--------------------|----------------------|-----------|-----------|--------------------|---|--|
| ITEM | CONNECTOR PART NO. | DESCRIPTION | IPI CHECK | EOR CHECK | Applicable Tooling | | |
| 1 | SEH-001T-P0.6 | EH CONNECTOR CONTACT | | | APPLICATOR | | |
| 2 | UL1007, 22 AWG | BLACK | | | | | |

Applicable Housings

| NO. OF CIRCUITS | HOUSING PART NO. |
|-----------------|------------------|
| 2 | EHR-2 |
| 3 | EHR-3 |
| 4 | EHR-4 |
| 5 | EHR-5 |
| 6 | EHR-6 |
| 7 | EHR-7 |
| 8 | EHR-8 |
| 9 | EHR-9 |
| 10 | EHR-10 |
| 11 | EHR-11 |
| 12 | EHR-12 |
| 13 | EHR-13 |
| 14 | EHR-14 |
| 15 | EHR-15 |

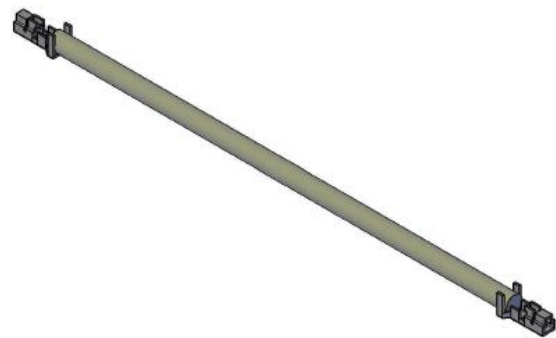
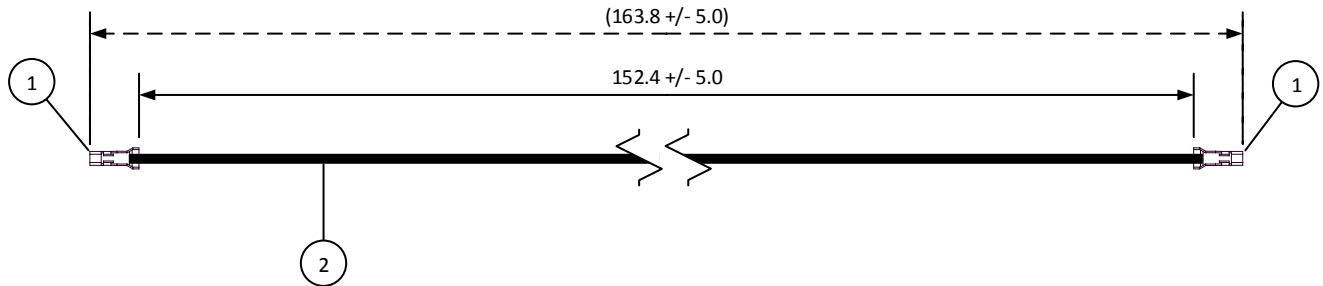

| | | |
|--|---|---------------------|
| SCALE 1:1 | CUSTOMER NAME | CUSTOMER PART NO. |
| DIMENSIONS All dimensions are in MM with a tolerance of +/- 3.0 unless otherwise specified. | DESCRIPTION 2.5 mm Pitch EH Series Standard Leads - 6" Inside Length DOUBLE-END LEADS | |
| DRAWN BY STEVEN PILKINGTON | ASSEMBLY PART NO. ASEHSEH22K152 | |
| CHECKED BY JUSTIN BAKER | DRAWING NO. & REVISION GAM-080 | REVISED 3/9/2016 |

| REV. | DESCRIPTION | DATE | BY |
|------|-------------|------|----|
| | | | |